



Amberglenn Corporate Center
2345 NW Amberbrook Drive
Hillsboro, Oregon



PREMIER
SUBURBAN
LOCATION



LOCATION
HILLSBORO, OR



PROPERTY SIZE
132,876 RSF



BUILDINGS
2



FLOORS
2



FLOOR PLATE
33,224 RSF



PARKING
4:1,000

Welcome to

AMBERGLEN CORPORATE CTR.

An institutional grade office/flex project located in the heart of the Sunset Corridor/I-26 submarket, an easy 17 minute drive from downtown Portland.

- **Recent improvements include renovated lobby and outdoor seating area**
- Premier corporate campus located close to I-26 and adjacent to many retail amenities
- Campus-like setting with plenty of green space, jogging paths and a lake
- Visible to traffic along Cornell Road
- One-half mile to Streets of Tansabourne

Property FEATURES





**OUTDOOR
DINING**



**COMMON
AREAS**



**RECREATIONAL
AREA**



Property LOCATION

2345 NW Amberbrook Drive

2430 NW Amberbrook Drive



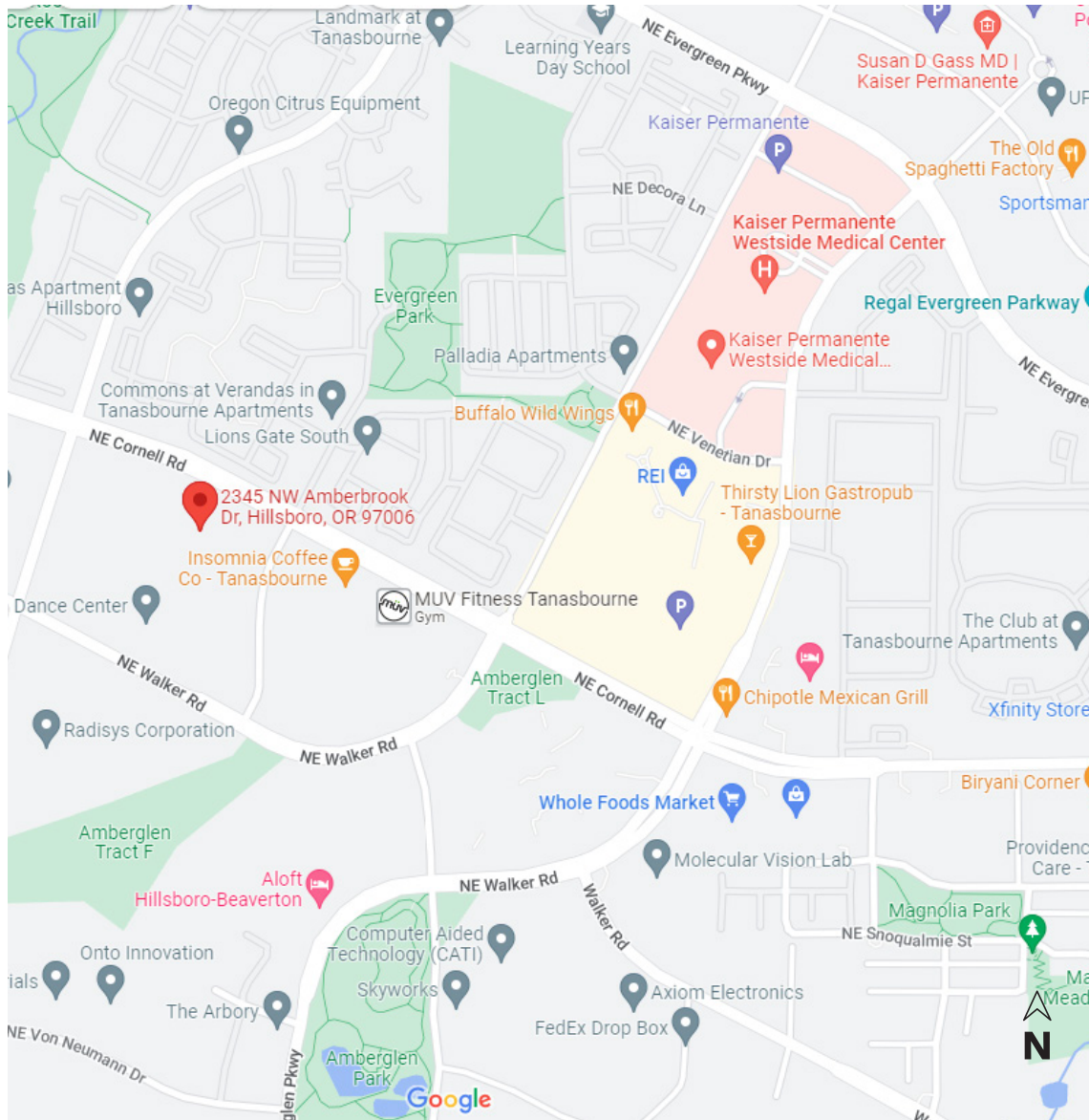

RESTAURANTS
50+, 5 MILES



HOTELS
22, 5 MILES



RETAIL
STREETS OF
TANASBOURNE



APARTMENTS
20, 5 MILES

Typical FLOOR PLATE

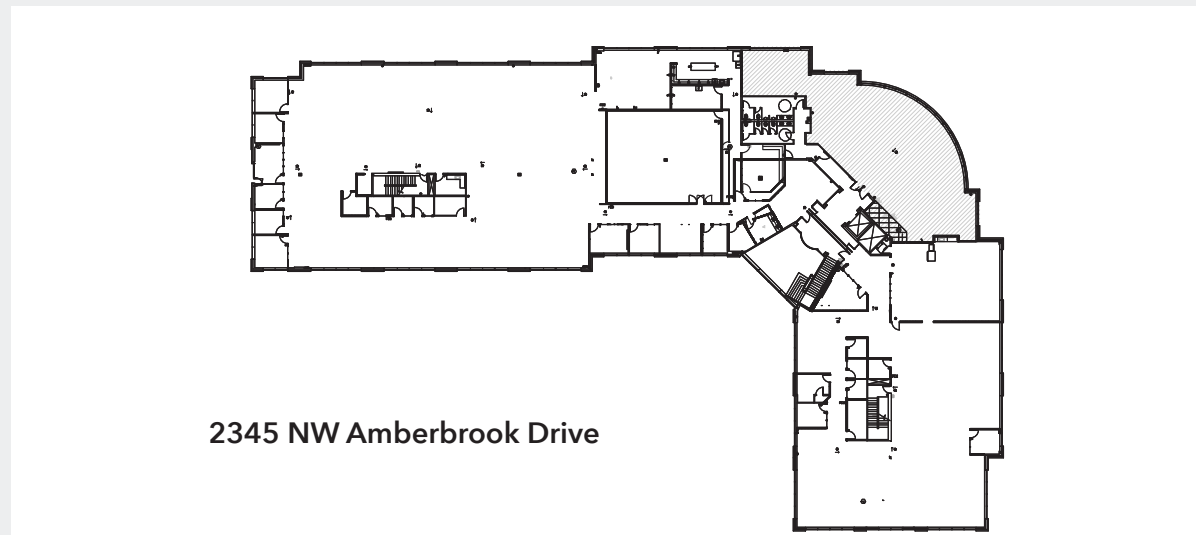

NOT TO SCALE



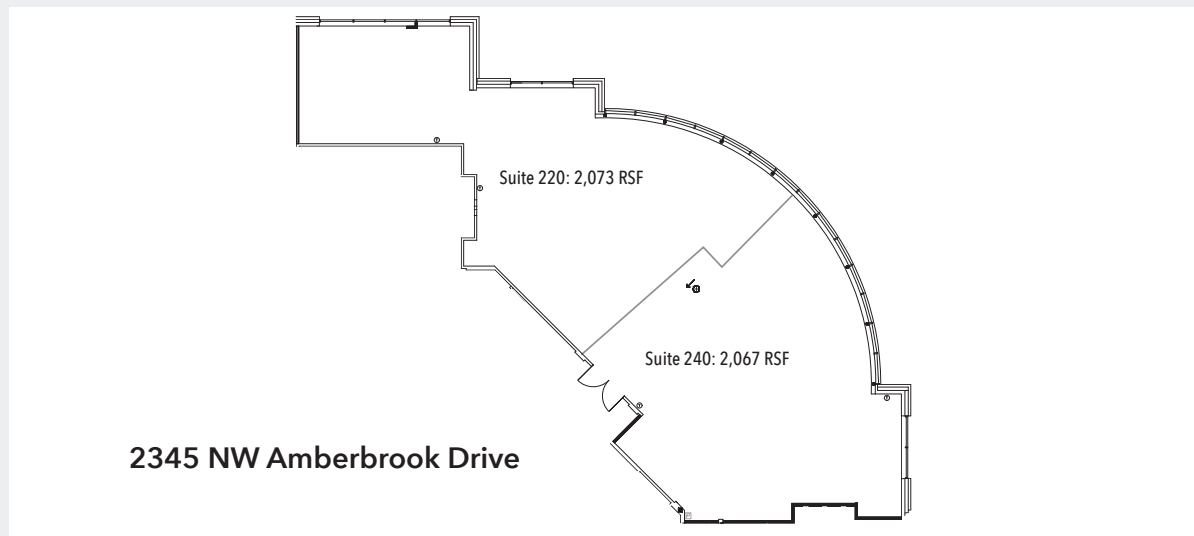

NOT TO SCALE

AVAILABILITY RANGES FROM
2,073 - 14,456 RSF

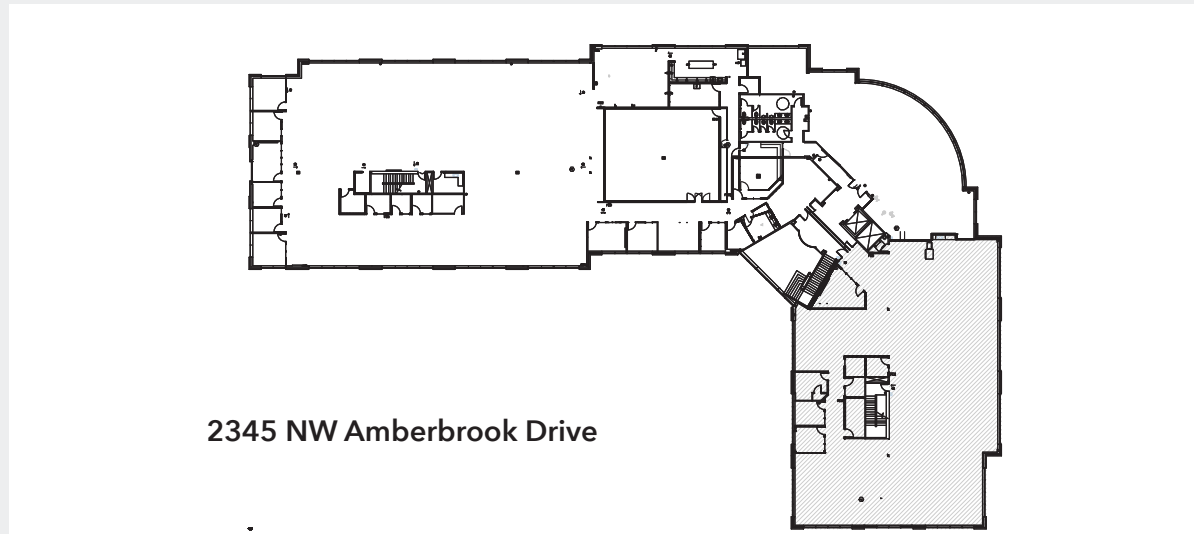

NOT TO SCALE

APPROXIMATELY 10,316 RSF
AVAILABLE

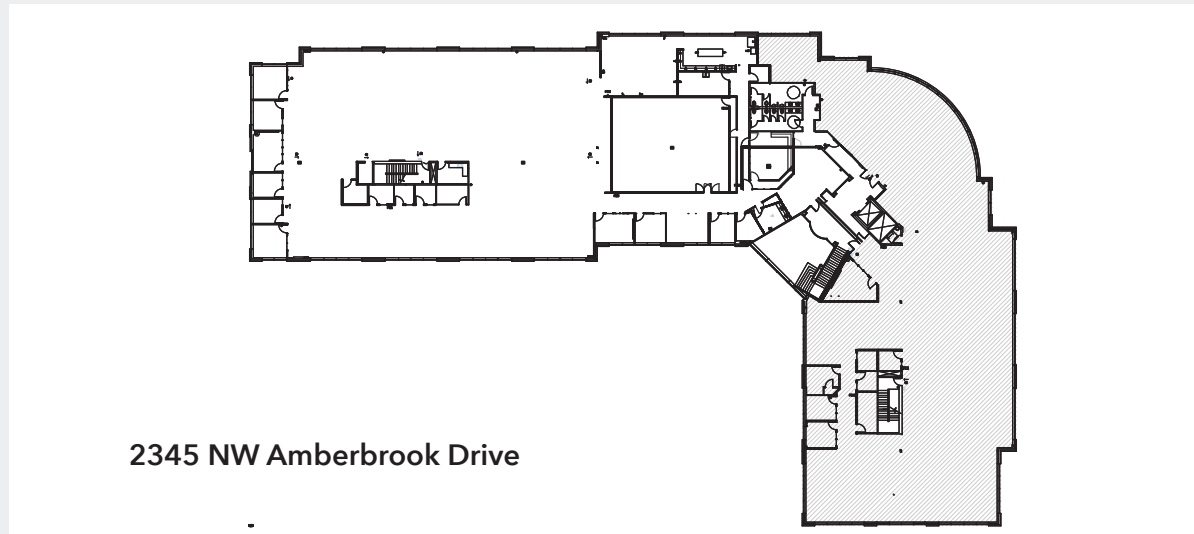

NOT TO SCALE

APPROXIMATELY 14,456 RSF
AVAILABLE



JEFF BORLAUG

503.227.5799

jeff@feltonprop.com

[Click For Available Spaces](#)

[Click For Printable Brochure](#)



© Copyright 2022 | All Rights Reserved